

3

2

1

NOTES:

- 1 ALL DIMENSIONS SHOWN ARE IN Inches (mm)
- 2 ALL DIMENSIONS SHOWN ARE FINISH OPERATIONAL DIMENSIONS WHICH INCLUDE RESIDUAL COATINGS UNLESS OTHERWISE SPECIFIED.
- 3 PART TO BE FLAT PACKED PROPERLY TO AVOID ANY DAMAGE WHILE SHIPPING & HANDLING.
- 4 ALL HORIZONTAL DIMENSIONS ARE SYMMETRICAL ABOUT VERTICAL CENTER LINE UNLESS OTHERWISE SPECIFIED.

REVISIONS			
REV	DESCRIPTION	DATE	APPROVED
-	-	-	-

E

E

D

D

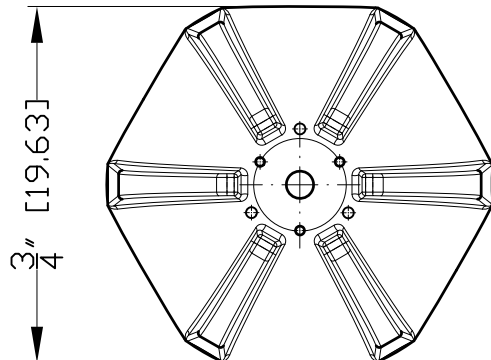

C

C

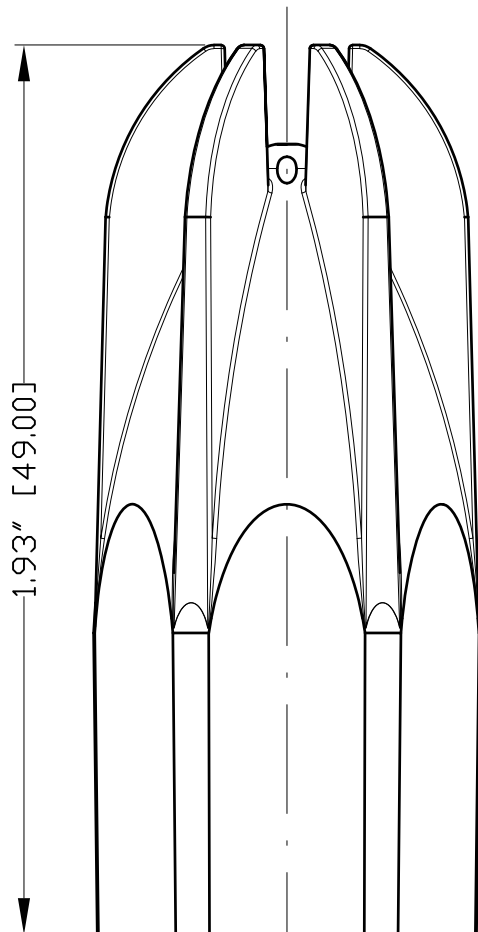

B

B

1/4" BSP INLET

A

A

THIRD ANGLE PROJECTION		REQUIREMENTS—UNLESS OTHERWISE SPECIFIED	CONTRACT NUMBER --	NEX FLOW AIR PRODUCTS CORP.				
		GENERAL	CLIENT --	10520 YONGE STREET, UNIT 35B-220, RICHMOND HILL, ON L4C 3C7				
MATERIAL	CAST ZINC	1. DIMS ARE IN INCHES (MM)	CONTRACTOR --	TEL.: (416) 410-1313 & FAX: (416) 410-1806 www.nex-flow.com				
		2. DIMENSIONING AND TOLERANCING IN ACCORDANCE WITH ANSI Y14.5 (1982)	DRAWN CHIRAG.S	DATE 01/01/2016	TITLE			AIR MAG™ NOZZLE
FINISH	-	3. MACHINE FINISH 125 MICRO INCH RMS	DESIGN --	CHECKED ASHISH	SIZE			
		4. INTERNAL RADII .015	PROJECT --	Q.A. --	CAGE CODE	PART NAME	RELEASE	REV
		5. BREAK SHARP CORNERS .005 TO .015	STRESS --	MANUFACTURING --	-	47004 AMF	-	-
		LIMITS	THERMAL --	MATERIALS --	SCALE			1:1
		1. LINEAR DIMS.	MECHANISM --	ELECTRICAL --	CAD NO	SHEET	1	OF 1
		.00X = .005						
		.0X = .010						
		.X = .030						
		2. ANGLES = ± 1/2"						
		3. RUNOUT .010 TIR						
		4. HOLES IN ACCORDANCE WITH AND 10387						

3

2

1