

3 2 1

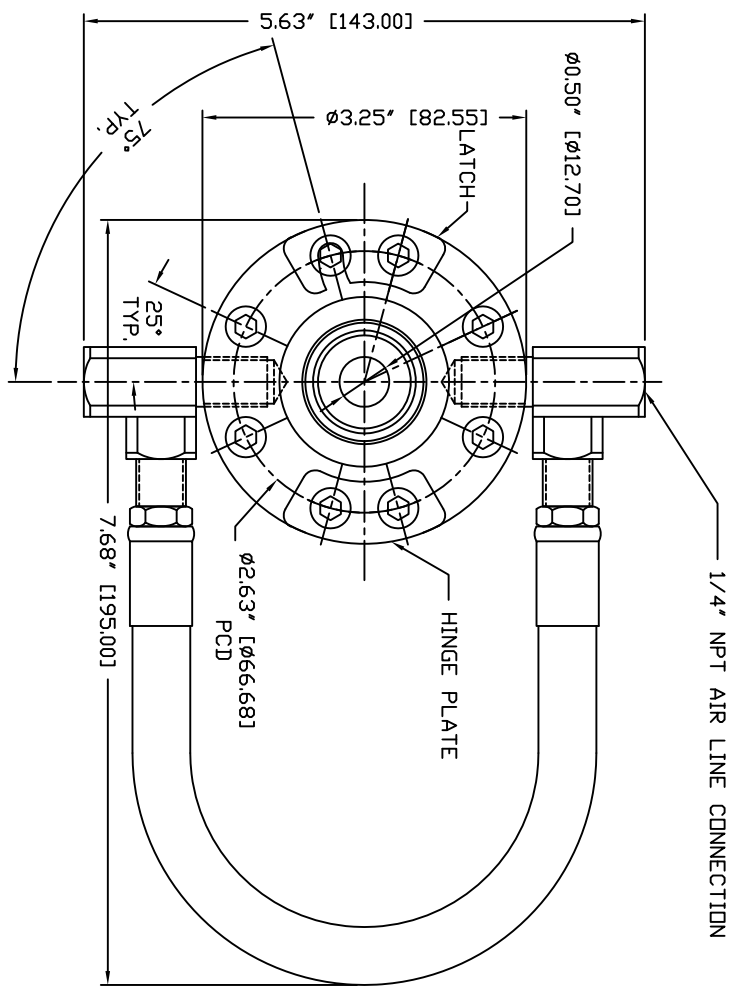
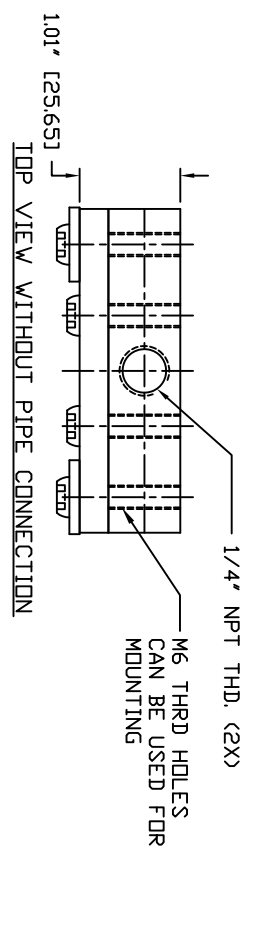

THIRD ANGLE PROJECTION		
	<p>REQUIREMENTS - FINISHES OTHERWISE SPECIFIED GENERAL</p>	
MATERIAL	<p>1. DIMS ARE IN INCHES (MM) 2. DIMENSIONING AND TOLERANCING (ASME) 3. MACHINING FINISH 125 MICRO INCH RMS 4. INTERNAL RADIUS 0.125 MICRO INCH RMS 5. BREAK SHARP CORNERS .005 TO .015</p>	
FINISH	<p>LIMITS</p> <p>1. LINEAR DIMS. .XXX = .005 .XX = .010 .X = .015 2. ANGLES = ± 1/2° 3. ROUNDT 0.10 TIR 4. HOLES IN ACCORDANCE WITH AND 10387</p>	
	<p>CONTRACT NUMBER - CLIENT - CONTRACTOR -</p>	
<p>DRAWN DATE 10/04/2015 CHECKED DESIGN OASHTSH G.I.A.</p>		
<p>STRESS - THERMAL - MECHANISM -</p>		
<p>MANUFACTURING MATERIALS ELECTRICAL</p>		
<p>SIZE CASE CODE DWG NO 20000 SCALE 1:1 CND NO 0.5"-RB SHEET 1 OF 1</p>		
<p>TITLE NEX FLOW AIR PRODUCTS CORP. 10520 YONGE STREET, UNIT 35B-220, RICHMOND HILL, ON L4C 3C7 TEL: (416) 410-1313 & FAX: (416) 410-1806 WWW.NEX-FLOW.COM</p>		

OUTLINE DRAWING OF
1/2" RING BLADE

A B C 3 2 1